

Tubes & Fittings



Tubes & Fittings Accessories

Sheet Metal Products

Pressed Swivel Coupler (M.D.)

Used to connect two scaffolding tubes at any angle. These are key components in the structure and must be load bearing. The body is firmly riveted to permit rotation but still ensures the minimum of further movement for maximum rigidity.

Code	Size (m)
XFGCSP4848	1.5" x 1.5" (Pressed)
XFGCSP6048	2.0" x 1.5" (Pressed)



Pressed Swivel Coupler (M. D.)

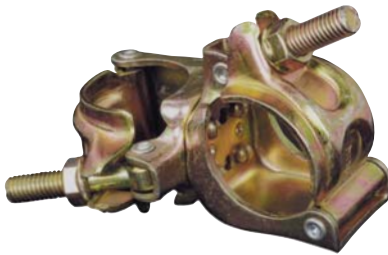

Pressed Double Coupler (M.D.)

Pressed Double Coupler (M.D.)

Used to connect two scaffolding tubes at right angles. These are critical components in the scaffolding structure and must be load bearing to resist both slip and distortion.

Code	Size (m)
XFGCDP4848	1.5" x 1.5" (Pressed)
XFGCDP6048	2.0" x 1.5" (Pressed)

Fixed Final Coupler

Connect a scaffolding tube at right angle directly to the end of another tube with no projection. Ideal for guard rails, crowd control barriers etc.

Code
XFGCFEP

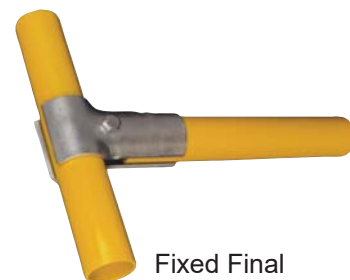

Fixed Final



Pressed Sleeve Coupler

Pressed Sleeve Coupler

Used to join two scaffolding tubes externally end to end. A steel divider located centrally ensures equal insertion of each tube. They can be employed where tension joints are required.

Code
XFGCSP001

DH Putlog Coupler

This coupler is designed to secure putlogs and transoms to ledger. It also conforms to the requirements for bracing coupler as it is capable of taking much higher loading than normal putlog couplers.

Code

XFGPCDPE



Band and Plate Coupler



DH Putlog Coupler

Band and Plate Coupler

The original load bearing coupler for connecting two scaffold tubes at right angles. This is the only 90 degree coupler that can also bear scaffold tube in parallel.

Code

XFGCBPP01

Joint Pin

Used to connect two scaffolding tubes end to end. Fitted internally it expands to apply maximum grip against the wall of the tube. Not suitable for joints where tension can be developed in the tube.

Code

XFGJPP01



Joint Pin



Patent Clamp

Patent Clamp

This is a highly economical fitting for fastening scaffolding tubes to girders with a single bolt. Suitable for loads at right angles to flanges only. Must be used in pairs.

Code

XFGCPP001

Base Plate

A 120 mm x 120 mm steel plate providing a full bearing surface for load distribution from vertical.

Code

Size (m)

FBP27HP1012 Base Plate 27H-12x12 cm

FBP27HP1015 Base Plate 27H-15x15 cm

FBP38HP1012 Base Plate 38H-12x12 cm

FBP38HP1015 Base Plate 38H-15x15 cm



Base Plate

Tubes & Fittings Accessories

Drop Forged Products

Drop Forged Swivel Coupler (H.D.)

A one-piece load bearing coupler of rugged design incorporating captive "T" bolts for connecting two scaffold tubes at any angle.

Code

XFGCSD4848



Drop Forged Swivel Coupler (H. D.)

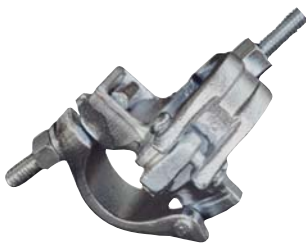

Drop Forged Double Coupler (H. D.)

Drop Forged Double Coupler (H.D.)

A one-piece load bearing coupler incorporating captive "T" bolts used to connecting two scaffold tubes at right angles.

Code

XFGCDD4848

Drop Forged Putlog Coupler

A one-piece coupler for connecting transoms and putlog to ledgers.

Code

XFGCPD001



Drop Forged Putlog Coupler



Gravlock Coupler

Gravlock Coupler

There are often requirements to fasten scaffolding tubes to girder and other steel sections and it demands a specialised fitting with a high degree of versatility. The Gravlock Coupler has been specifically designed for attachment to either horizontal or vertical Flanges. In erection the Gravlock Coupler is highly effective as it enables the fitting to be bolted to the girder first. This leaves both hands free to present and secure the tube. As the tube is not compressed against the girder it is not distorted by the fastening process. Gravlock Coupler must be used in pair.

Code

XFGCGD001

Soldier System Accessories

Tie Rod

Threaded high tensile tie rod supplied in 6 m lengths and 17 mm diameter, black or galvanized.

Size (m)	Code
Tie Rod 15 cm	XFGTRB015
Tie Rod 25 cm	XFGTRB025
Tie Rod 50 cm	XFGTRB050
Tie Rod 75 cm	XFGTRB075
Tie Rod 100 cm	XFGTRB100
Tie Rod 125 cm	XFGTRB125
Tie Rod 150 cm	XFGTRB150
Tie Rod 175 cm	XFGTRB175
Tie Rod 200 cm	XFGTRB200
Tie Rod 225 cm	XFGTRB225
Tie Rod 250 cm	XFGTRB250
Tie Rod 275 cm	XFGTRB275
Tie Rod 300 cm	XFGTRB300
Tie Rod 325 cm	XFGTRB325
Tie Rod 350 cm	XFGTRB350
Tie Rod 375 cm	XFGTRB375
Tie Rod 400 cm	XFGTRB400
Tie Rod 425 cm	XFGTRB425
Tie Rod 450 cm	XFGTRB450
Tie Rod 475 cm	XFGTRB475
Tie Rod 500 cm	XFGTRB500
Tie Rod 525 cm	XFGTRB525
Tie Rod 550 cm	XFGTRB550
Tie Rod 575 cm	XFGTRB575
Tie Rod 600 cm	XFGTRB600



Tie Rod



Timber Waling Clamp



Universal Clamp

Timber Waling Clamp & Universal Clamp

Both devices used for soldier wall shuttering system. Waling clamp used to connect timber studs to the soldiers, while the Universal Clamp is used to fasten the aluminum studs to the soldiers. Wall formwork is easily done with these accessories.

Timber Waling Clamp

Code

FSS99E028

Universal Clamp

Code

FSS99E027

Soldier System Accessories

Plastic Sleeve

Acts as a spacer and allows the recovery of the tie rod by preventing contact with the concrete.

Code

XFGPSL100



Plastic Sleeve



Plastic Cone

Plastic Cone

Located at the ends of the plastic sleeve, cone allows the tie rod to penetrate easily one side to another.

Code

XFGCONE

Counter Plate

A simple heavy duty reinforced plate 120 x120 x 8 mm.

Code

Size (m)

XFGCP80E12 12 x 12 cm

XFGCP80E15 15 x 15 cm



Counter Plate



Water Stopper

Water Stopper

Cast element used as a connector between two tie rods, which prevents water seepage due to its central disk.

Water Stopper

Code

Size (m)

GI Finish

XFGWSE

12 cm



Plastic Reducer

Plastic Reducer

Code

XFGPR

Wing Nut

Cast nut with lever arm action used counter plate for all soldiers or waling applications. Supplied either in black or galvanized.

Code

XFGWNUTE



Anchor Nut



Wing Nut

Scaffolding Accessories

Toe Board Clamp

Code

XFGTBC



Toe Board Clamp



Castor Wheel

Castor Wheel

Castor Wheel 8"

Code

XEXCW002

Castor Wheel 8" with Adjustable Jack

Code

XEXCW001



Abu Dhabi

Dubai

T: +971 2 5500688

T: +971 4 8862855

F: +971 2 5500689

F: +971 4 5562558

P.O. BOX: 41851, Abu Dhabi, UAE

P.O. BOX: 18234, Jebel Ali, UAE

WWW.SCAFFCO.COM